

# Uniden®

## UWS1100

Accessory Indoor Camera  
for UWS1101  
Surveillance System

# OWNER'S MANUAL

# UWS1100 Accessory Camera Owner's Manual

## What's in the Box



Portable video camera

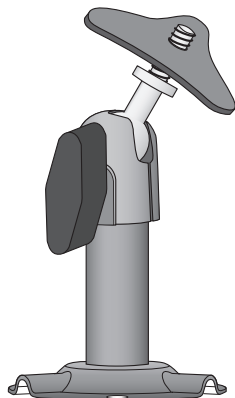

Camera stand



AC adapter

***If any items are missing or damaged, contact your place of purchase immediately.***

***Never use damaged products!***

**Need Help? Get answers at our website:  
[www.uniden.com.au](http://www.uniden.com.au) for Australian model or  
[www.uniden.co.nz](http://www.uniden.co.nz) for New Zealand model.**

# Important Safety Instructions!

**This manual contains important information about this product's operation. If you are installing this product for others, you must leave this manual or a copy with the end user.**

When using your equipment, always follow basic safety precautions to reduce the risk of fire, electric shock and injury to persons, including the following:

- ❑ This equipment is NOT waterproof. DO NOT expose it to rain or moisture.
- ❑ DO NOT immerse any part of the product in water. Do not use this product near water, e.g., near a bath tub, wash bowl, kitchen sink or laundry tub, in a wet basement or near a swimming pool.
- ❑ To avoid any risk of electric shock from lightning, avoid handling any electronic devices (except battery powered ones) during an electrical storm.
- ❑ Use only the power cord and/or batteries indicated in this manual. Never dispose of any batteries in a fire: they may explode. Check with local codes for possible special disposal instructions.
- ❑ Never tug or pull on any power cord: be sure to leave some slack in the cord when placing your equipment, and always use the plug to unplug cord from the wall outlet.
- ❑ Never leave power cords where they can become crushed, cut, or frayed; when running power cords, avoid letting them rub against any sharp edges or lie across any high traffic areas where people might trip over them.
- ❑ Do not use the device if the adapter cords or plugs have been damaged, the unit has been exposed to liquids, or the unit has been dropped or is damaged.

## Warnings to Parents and Other Users

Failure to follow these warnings and the assembly instructions could result in serious injury or death. This product is not designed or intended for use as a medical monitor, nor should this product be used as a substitution for medial or parental supervision. Always be sure that both the transmitter and receiver are working properly and are within range of each other.

- ❑ STRANGULATION HAZARD. Keep the adapter cords out of the reach of children.
- ❑ WARNING: KEEP OUT OF THE REACH OF CHILDREN. This product is not a toy and is not intended for use by any children under the age of 13. If you are between the ages of 13 and 18, review these terms, conditions and safety warnings with your parents or guardian

to make sure that you and your parent or guardian understand these terms, conditions, and safety warnings.

- Allow for proper ventilation when units are in use. Do not cover the camera or receiver with any object such as a blanket. Do not place it in a drawer or in any location which would muffle the sound or interfere with the normal flow of air.

### **SAVE THESE INSTRUCTIONS!**

#### **For best results:**

To avoid damage to your equipment, follow these simple precautions:

- Do not drop, puncture or disassemble any part of the equipment. There are no user-serviceable parts inside.
- Do not expose the equipment to high temperatures, and avoid leaving the equipment in direct sunlight for more than a few minutes. Heat can damage the case or electrical parts.
- Do not place heavy items on top of the equipment or expose the equipment to heavy pressure.
- Remove the power adapter during long periods between usages.
- Clean only with a dry cloth.

**Failure to follow the instructions in this operating manual will void the warranty. Uniden assumes no liability for damages to property or injury to persons caused by improper handling or failure to comply with these safety instructions.**

## **Contents**

|   |          |  |           |
|---|----------|--|-----------|
| <b>Important Safety Instructions! .....</b> | <b>2</b> | <b>Pairing the Camera.....</b>               | <b>7</b>  |
| Warnings to Parents and Other Users .....   | 2        | <b>Additional Information .....</b>          | <b>8</b>  |
| For best results:.....                      | 3        | Product Specifications.....                  | 8         |
| <b>Getting Started .....</b>                | <b>4</b> | <b>Polymer-Lithium Battery Warning .....</b> | <b>9</b>  |
| Connecting the Power.....                   | 4        | <b>One-year Limited Warranty .....</b>       | <b>11</b> |
| Charging the Batteries.....                 | 4        |  |           |
| Learning the Buttons and Lights .....       | 5        |  |           |
| Using the Camera Mount .....                | 5        |  |           |

# Getting Started

## Connecting the Power

1. Connect one end of the AC adapter to the camera's power connector and the other end to a standard 240 volt AC indoor outlet.
2. Press the **POWER** button on the camera; the *Power status* light should turn on. If it doesn't, try reconnecting the AC adapter, and make sure the power outlet isn't controlled by a wall switch.

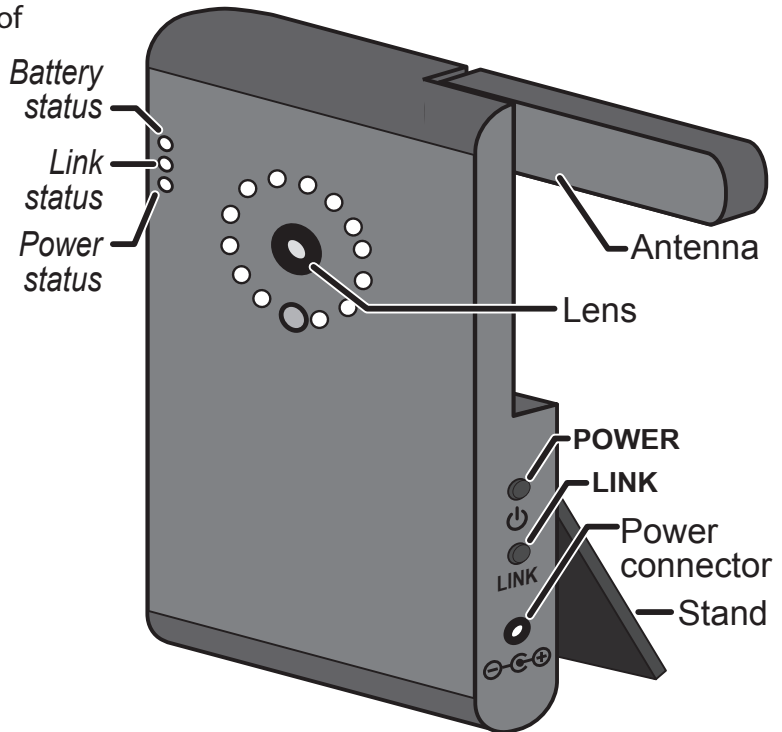

## Charging the Batteries

The batteries in your camera will charge whenever the power is connected. Let the batteries charge completely (about 8 hours) before you unplug the camera to move it around. (You can still use the camera: just keep it plugged in.)

## Learning the Buttons and Lights

| Button | What it does                                       |
|--------|--|
| POWER  | Turn the camera on. Press and hold to turn it off. |
| LINK   | Enter pairing mode.                                |

| Light                          | State    | What it means  |
|--------------------------------|----------|--|
| <i>Power Status</i><br>light   | On       | The camera is on.  |
|                                | Off      | The camera is off.   |
| <i>Link Status</i><br>light    | Flashing | The camera is in pairing mode.                             |
|                                | Orange   | The camera is connected to the receiver.                   |
|                                | Off      | The camera is in standby.                                  |
| <i>Battery Status</i><br>light | Green    | The battery is charging.                                   |
|                                | Red      | The battery is low; the camera will turn off in 3 minutes. |
|                                | Off      | The battery is fully charged.                              |

## Using the Camera Mount

The camera has a built-in stand so you can place it on any flat surface. If you want to place your camera on a wall or a ceiling (or even if you just want to secure it to a flat surface), you can use the included camera mount. (You might want to bring the receiver along when you mount the camera; it's much easier to get the camera into the right position when you have the display handy.)

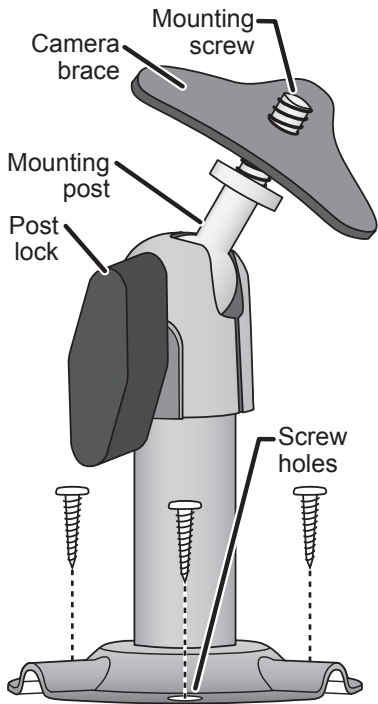

1. Hold the base of the mount where you want to attach it, and mark the location of the screw holes.
2. Use the included screws and anchors to attach the base to the wall or ceiling.
3. Attach the camera to the mounting screw. Tighten it a few turns, then turn it to the direction you want.
4. Tighten the camera brace up against the back of the camera to secure it into place.
5. Unlock the mounting post by turning the wingnut to the left a few turns.
6. Set the mounting post to the correct angle, then tighten the wingnut until the post is locked into place.

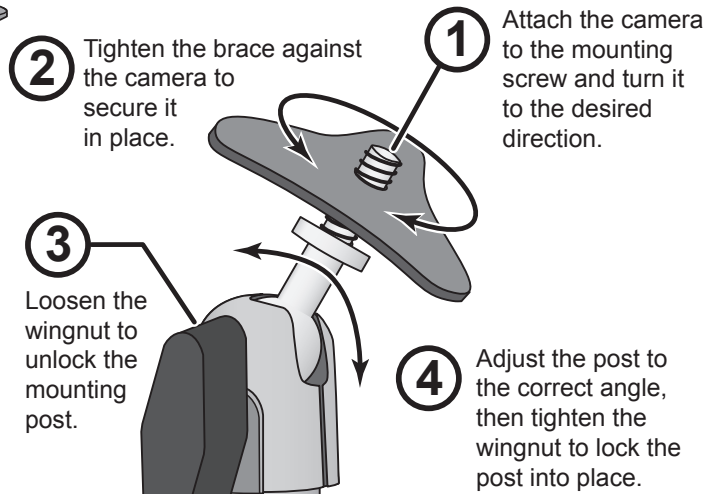

# Pairing the Camera

Before you can use the camera, you'll need to "introduce" or pair it to the receiver so they can communicate. You might also perform the pairing procedure if you are having trouble with the camera.

1. Make sure the camera is powered on.
2. On the receiver, select the channel you want to pair this camera to, and put the receiver into pairing mode. (This process is slightly different on each receiver. See the manual that came with your receiver for instructions.)
3. On the camera, press **LINK** to put the camera into pairing mode.
4. Switch the receiver to this camera's channel, and verify that the camera's video signal appears on the correct channel. (You might have to enable the new channel first.)

For more information about pairing a camera to your receiver, see the manual that came with your receiver.

| <b>If...</b>   | <b>Try...</b>  |
|--|--|
| the receiver's signal status icon shows no bars or the display says <i>No Signal</i> | <ul style="list-style-type: none"><li>- making sure the camera is turned on</li><li>- making sure the camera is paired to the correct channel</li><li>- re-pairing the camera and receiver</li></ul> |
| the signal status icon shows one or two bars or the video quality is poor            | see the manual that came with your receiver for tips on improving video quality  |
| there is a lot of static on the receiver   | see the manual that came with your receiver for tips on improving video quality  |

# Additional Information

## Product Specifications

| <b>Radio Frequency Transceiver</b> |   |
|------------------------------------|---|
| RF Frequency                       | 2402 Mhz ~ 2483.5 Mhz                               |
| Modulation                         | GFSK  |
| Spread spectrum                    | Frequency Hopping                                   |
| Anti Interference                  | Clean Channel Dynamic Select                        |
| Data rate                          | 2 Mbps  |
| Channel bandwidth                  | 2 MHz   |
| Transmitting range                 | 200 meters/600 feet in an open area (line of sight) |

| <b>Image Specification</b> |                                   |
|----------------------------|-----------------------------------|
| Output Image resolution    | 640 x 480 (VGA)/ 320 x 240 (QVGA) |
| Image processing           | Motion JPEG                       |
| Exposure                   | Auto                              |
| White balance              | Auto                              |

| <b>Camera Specifications</b> |                                     |
|------------------------------|-------------------------------------|
| Weight                       | 110 g                               |
| Dimension                    | 115 x 60 x 19 mm                    |
| Operating temperature        | -10° C (+14° F) to +50° C (122° F ) |
| Battery charging temp.       | 0° C (32° F) to +45° C (113° F )    |
| Input voltage                | 100-240 V AC @ 60 or 50 Hz          |
| Operating voltage            | 5 V DC @ 1 Amp                      |
| Power consumption            | 650 mA max                          |

| <b>Camera Specifications</b> |                                |
|------------------------------|--------------------------------|
| Low light solution           | 11 IR LEDs, 1 Low light sensor |
| Low light sensitivity        | 1-8 lux                        |
| Picture sensor               | OV7725 1/4' Color CMOS         |
| Lens                         | F3.6mm H:53 V:40               |

## **Polymer-Lithium Battery Warning**

**This receiver and camera contains a lithium-polymer battery. The battery must be recycled or disposed of properly. Contact your local waste management office for information on battery recycling or disposal.**

# One-year Limited Warranty

## UWS1100 Accessory Indoor Camera

### **IMPORTANT Satisfactory evidence of the original purchase is required for warranty service**

Please refer to our Uniden website for any details or warranty durations offered in addition to those contained below.

#### **Warrantor**

The warrantor is either Uniden Australia Pty Limited ABN 58 001 865 498 ("Uniden Aust") or Uniden New Zealand Limited ("Uniden NZ") as the case may be.

#### **Terms of Warranty**

Uniden Aust/NZ warrants to the original retail purchaser only that the UWS 1100 ("the Product"), will be free from defects in materials and craftsmanship for the duration of the warranty period, subject to the limitations and exclusions set out below.

#### **Warranty Period**

This warranty to the original retail purchaser is only valid in the original country of purchase for a Product first purchased either in Australia or New Zealand and will expire one (1) year from the date of the original retail sale.

If a warranty claim is made, this warranty will not apply if the Product is found by Uniden to be:

- (A) Damaged or not maintained in a reasonable manner or as recommended in the relevant Uniden Owner's Manual;
- (B) Modified, altered or used as part of any conversion kits, subassemblies or any configurations not sold by Uniden Aust or Uniden NZ;
- (C) Improperly installed contrary to instructions contained in the relevant Owner's Manual
- (D) Repaired by someone other than an authorized Uniden Repair Agent in relation to a defect or malfunction covered by this warranty; or
- (E) Used in conjunction with any equipment, parts or a system not manufactured by Uniden.

#### **Parts Covered**

This warranty covers the Product and included accessories.

#### **User-generated Data**

This warranty does not cover any claimed loss of or damage to user-generated data (including but without limitation phone numbers, addresses and images) that may be stored on your Product.

#### **Statement of Remedy**

If the Product is found not to conform to this warranty as stated above, the Warrantor, at its discretion, will either repair the defect or replace the Product without any charge for parts or service. This warranty does not include any reimbursement or payment of any consequential damages claimed to arise from a Product's failure to comply with the warranty.

Our goods come with guarantees that cannot be excluded under the Australian Consumer Law. You are entitled to a replacement or refund for a major failure and for compensation for any other reasonably foreseeable loss or damage. You are also entitled to have the goods repaired or replaced if the goods fail to be of acceptable quality and the failure does not amount to a major failure.

This warranty is in addition to and sits alongside your rights under either the COMPETITION AND CONSUMER ACT 2010 (Australia) or the CONSUMER GUARANTEES ACT (New Zealand) as the case may be, none of which can be excluded.

#### **Procedure for Obtaining Warranty Service**

Depending on the country in which the Product was first purchased, if you believe that your Product does not conform with this warranty, you should deliver the Product, together with satisfactory evidence of your original purchase (such as a legible copy of the sales docket) to Uniden at the addresses shown below. You should contact Uniden regarding any compensation that may be payable for your expenses incurred in making a warranty claim. Prior to delivery, we recommend that you make a backup copy of any phone numbers, images or other data stored on your Product, in case it is lost or damaged during warranty service.

#### **UNIDEN AUSTRALIA PTY LTD**

Service Division  
345 Princes Highway,  
Rockdale, NSW 2216  
Phone number: 1300 366 895  
Email address: [custservice@uniden.com.au](mailto:custservice@uniden.com.au)

#### **UNIDEN NEW ZEALAND LTD**

Service Division  
150 Harris Road, East Tamaki  
Auckland 2013  
Phone number: (09) 273 8377  
Email address: [service@uniden.co.nz](mailto:service@uniden.co.nz)

**Uniden®**

© 2011 Uniden Australia Pty Ltd/Uniden New Zealand Limited  
Printed in PRC